

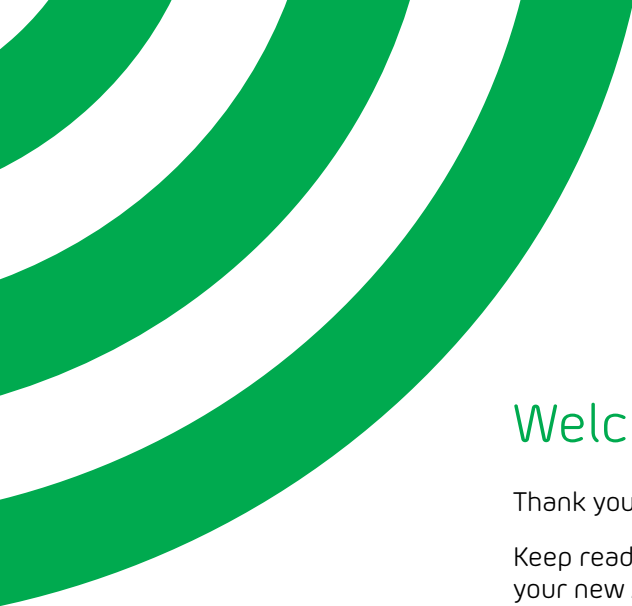

arlo®

Arlo Pro
Quick Start Guide



Welcome

Thank you for choosing Arlo.

Keep reading for important info to help you get your new Arlo System up and running.

If you need help, contact Arlo before returning your product to the store. Most questions can be answered through our online support center at [arlo.com/support](https://www.arlo.com/support).

What's in the box



Arlo Pro base station



Arlo Pro camera



Camera cable



Base station AC power adapter



Rechargeable battery



Wall mount



Ethernet cable



Camera power adapter



Mounting screws and anchors

Get the app

Download the free Arlo app to get started.

The app guides you through the setup and installation of your base station and camera.



Place or mount your camera

You can place your camera on a flat surface or you can mount it to a wall. Choose a location with a clear, unblocked field of view and with a good signal to your base station.

Note: WiFi range can be affected by building materials or objects that block WiFi signals and by interference from other WiFi networks.

➤ To use the wall mount:

1. Fasten the mounting screw into the wall.
If you're mounting the camera to drywall, use the plastic drywall anchors that are provided.
2. Hang the mount from the screw.

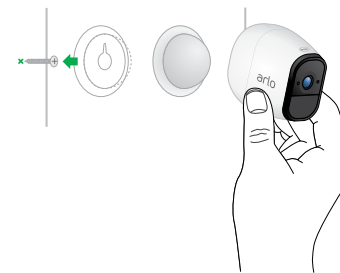

Charge your camera battery

1. If you are using the camera outside, bring it inside to charge the battery.

2. Connect the camera cable to the power adapter.

Note: You must use the Arlo Pro camera power adapter that came with your camera.

3. Connect the camera cable to the camera.

4. Plug the power adapter into an indoor electrical outlet.

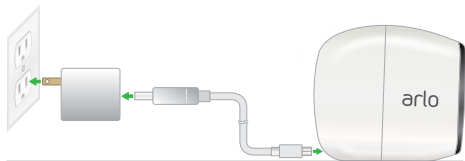

When the battery is charged, the camera LED lights solid blue.

Helpful tips

Motion detection

To optimize motion detection, do the following:

- Mount your Arlo camera at least 7 feet (2.1 meters) above the floor or ground and angle it slightly downward.
- Place your camera within 10-15 feet (3.0-4.6 meters) of where motion is expected.
- Make sure that side-to-side traffic crosses the camera's field of view.
- The best area for motion detection is 5 to 20 feet (1.5 to 6 meters) from the camera position.

Battery life

Use these tips to maximize your camera's battery life:

- Use the Optimized or Best Battery Life power setting.
- Configure your cameras to record shorter videos.
- Position your camera close to your base station, up to a maximum distance of 300 feet (90 meters).
- Do not place your Arlo system near multiple WiFi routers.

©2018 Arlo Technologies, Inc. Arlo, Arlo logo, and Every Angle Covered are trademarks of Arlo Technologies, Inc. App Store is a service mark of Apple Inc., registered in the U.S. and other countries. Google Play and the Google Play logo are trademarks of Google Inc. Amazon, Alexa and all related logos are trademarks of Amazon.com, Inc. or its affiliates. Other trademarks are for reference purposes only.

Compliance

For regulatory compliance information, visit www.arlo.com/about/regulatory/.



Arlo International, Ltd.
Floor 3, Building 3 University Technology Center
Curraheen Road, Cork, Ireland



Arlo Technologies, Inc.
2200 Faraday Ave. Suite 150
Carlsbad, CA 92008 USA

www.arlo.com

www.arlo.com/support

June 2018

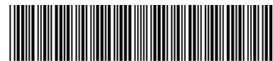

201-23710-01